



Land Group Partners, LLC
Specializing in land development and site construction



Strategic Land Acquisition

Land Group Partners excels at identifying and analyzing opportunities in areas of growth and opportunity. Through defined methodologies and applied technology we are quickly able to perform due diligence and feasibility analysis that facilitate quick decisions on opportunities when presented.

In this highly competitive market, time is of the essence and the old, random ways of locating land are not as effective. Our solution is designed to enhance productivity and responsiveness by delivering the most comprehensive, accurate, and pre-qualified information.

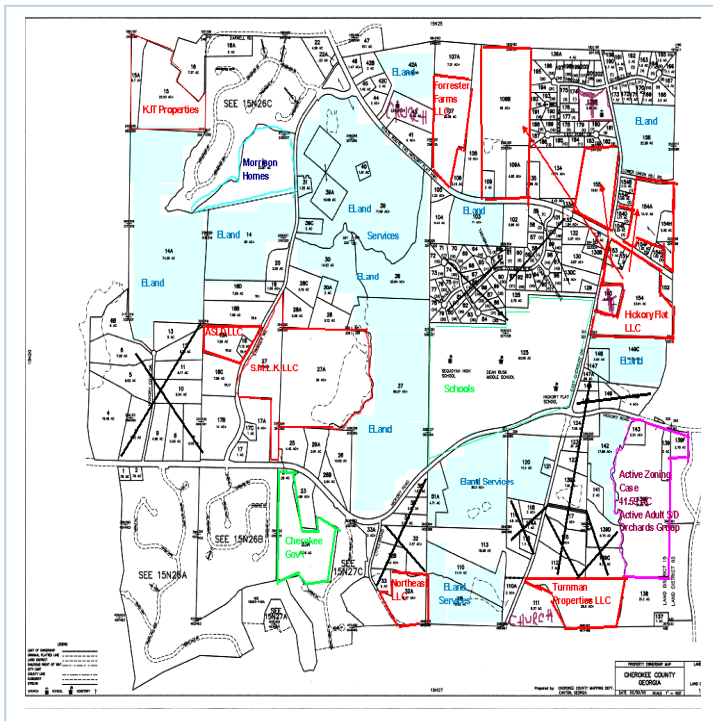

Analysis

This tile consists of 671 parcels with a total market value of \$182,158,400. Sub map parcel use is broken down as follows:

Sub map A	111 parcels	subdivision lots
Sub map B	140	subdivision lots
Sub map C	165	subdivision lots

Sub-Map Total: 416 parcels

Parcel Elimination (Main map only)

The Main Map has a total of 255 parcels of which 72 parcels are subdivision or lots less than 10 acres.

The remaining 183 parcels are broken down as follows:

- 36 are owned by LLC's or homebuilders (Morrison Homes owns 14 of these parcels)
- 3 are owned by a churches
- 3 are owned by schools or the county

Total parcels remaining – 141

Our research includes the identification of all property owners within a tile map, properties owned by investors, builders, and current zoning cases. Reports can further include demographic and school information, proposed county improvements, as well as other information requested by the client.

For quicker results and more comprehensive decision-making data, bundle our services to include due diligence on those properties of interest.

Land Group Partners, LLC

2265 Roswell Road Suite 100 Marietta, GA 30062

Chet Tischer

770.480.5676

www.landgrouppartners.com